

PART NUMBER	WEATHERHEAD CATALOG NUMBER	TH'D "T" <sub>1</sub>	TH'D "T" <sub>2</sub>	A REF	B REF	C REF	D REF	E REF	F REF	G REF
2041-3-3S	C5325X3BN	3/8-24	3/8-24	1.90	.48	1.11	.12	.12	.62	.62
2041-4-4S	C5325X4BN	7/16-20	7/16-20	2.07	.55	1.20	.17	.17	.69	.69
2041-4-6S	C5325X6X4BN	7/16-20	9/16-18	2.10	.56	1.20	.30	.17	.81	.69
2041-5-5S	C5325X5BN	1/2-20	1/2-20	2.07	.55	1.20	.23	.23	.75	.75
2041-6-6S	C5325X6BN	9/16-18	9/16-18	2.18	.56	1.28	.30	.30	.81	.81
2041-8-8S	C5325X8BN	3/4-16	3/4-16	2.44	.66	1.44	.39	.39	1.00	1.00
2041-10-10S	C5325X10BN	7/8-14	7/8-14	2.74	.76	1.58	.48	.48	1.12	1.12
2041-12-12S	C5325X12BN	1 1/16-12	1 1/16-12	3.09	.86	1.75	.61	.61	1.38	1.38
2041-12-16S	C5325X16X12BN	1 1/16-12	1 5/16-12	3.14	.91	1.75	.84	.61	1.62	1.38
2041-16-16S	C5325X16BN	1 5/16-12	1 5/16-12	3.14	.91	1.75	.84	.84	1.62	1.62
2041-20-20S	C5325X20BN	1 5/8-12	1 5/8-12	3.31	.96	1.80	1.08	1.08	1.88	1.88
2041-24-24S	C5325X24BN	1 7/8-12	1 7/8-12	3.52	1.08	1.81	1.31	1.31	2.12	2.12

REVISIONS			
REV	DESCRIPTION	DATE	APPROVED
P	(1) REDRAWN, ADDED WEATHERHEAD CATALOG NUMBER	2003-10-21 ATH	EN-F25118 DP-1513
R	(1) CATALOG NUMBER WAS C5325X"SIZE"	2004-12-09 BAT/BAL	EN-F27114 DP-1299

Ⓟ<sub>1</sub> Ⓟ<sub>1</sub>

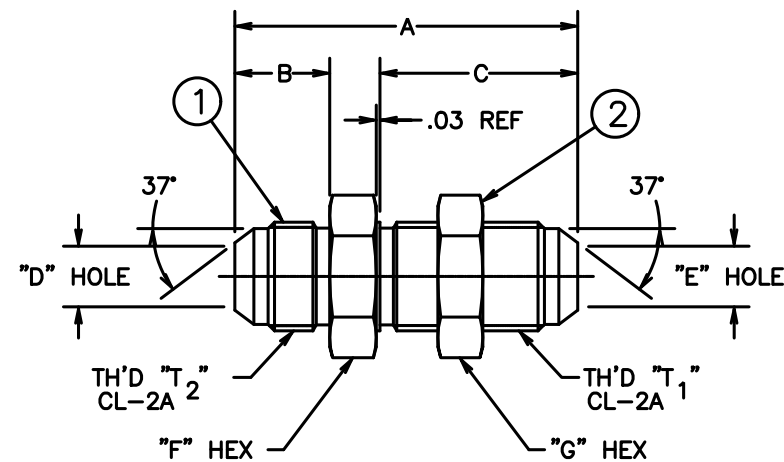

Ⓟ<sub>1</sub> Ⓟ<sub>1</sub>

2041-24-24S	C5325X24BN	2041-1-24-24S	210212-24S		
2041-20-20S	C5325X20BN	2041-1-20-20S	210212-20S		
2041-16-16S	C5325X16BN	2041-1-16-16S	210212-16S		
2041-12-16S	C5325X16X12BN	2041-1-12-16S	210212-12S		
2041-12-12S	C5325X12BN	2041-1-12-12S	210212-12S		
2041-10-10S	C5325X10BN	2041-1-10-10S	210212-10S		
2041-8-8S	C5325X8BN	2041-1-8-8S	210212-8S		
2041-6-6S	C5325X6BN	2041-1-6-6S	210212-6S		
2041-5-5S	C5325X5BN	2041-1-5-5S	210212-5S		
2041-4-6S	C5325X6X4BN	2041-1-4-6S	210212-4S		
2041-4-4S	C5325X4BN	2041-1-4-4S	210212-4S		
2041-3-3S	C5325X3BN	2041-1-3-3S	210212-3S		
PART NUMBER	WEATHERHEAD CATALOG NUMBER	Ⓟ <sub>1</sub> ADAPTER	Ⓟ <sub>2</sub> JAM NUT		

LIST OF MATERIALS

ITEM NO.	MATERIAL	DRAWN A. HISS	CHECKED B. THOMAS	APPROVED B. THOMAS	RELEASE DATE 2003-10-21	EN-F25118	DP-1513	THIRD ANGLE PROJECTION	SCALE	DIST	U	CAGE CODE	01276	SHEET	1
1	STEEL								A2						
2	STEEL														

**EATON** HYDRAULICS OPERATIONS  
TECHNICAL CENTER  
MAUMEE, OHIO, U.S.A.

DRAWING TITLE  
**ADAPTER**  
SAE 37° FLARE - BULKHEAD UNION  
(SAE #070601)

SIZE: A2    DRAWING NUMBER: 2041-S    REV: R

SCALE: NONE    DIST: U    CAGE CODE: 01276    SHEET: 1

NOTICE TO PERSONS RECEIVING THIS DRAWING AND / OR TECHNICAL INFORMATION  
Eaton Corporation claims proprietary rights in the information disclosed hereon. This document is issued in confidence and is not to be reproduced or used to manufacture anything shown hereon without the written permission of the Eaton Corporation.

2041-S  
SH. 1  
REV. R